



MML-AP***4BH

Floor Standing Concealed Type

Cool air makes for a pleasant indoor environment

Install it under a window and air-condition any room effectively.

Easy maintenance

Simplified design of fan and drainage pipe eases maintenance.

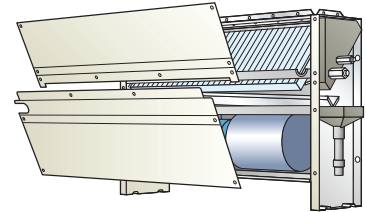

MML-AP0074BH to AP0244BH

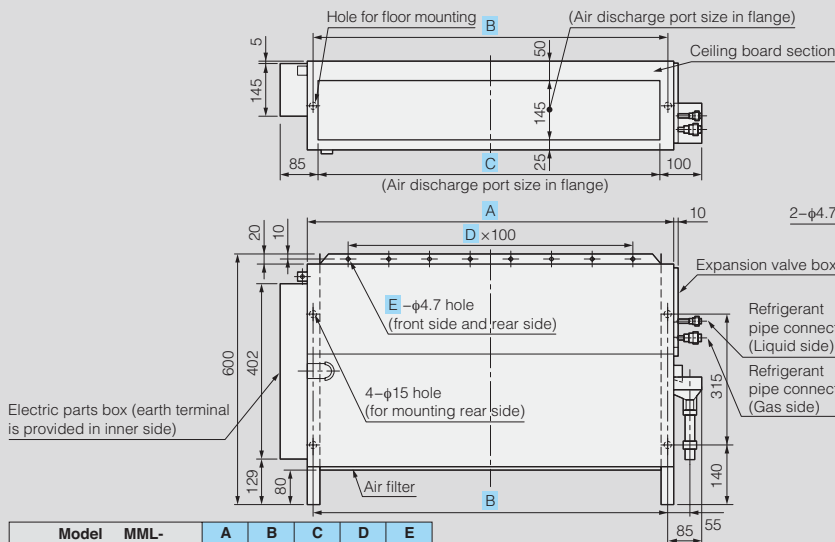

Model	MML-	A	B	C	D	E
AP0074BH to AP0124BH		610	580	550	4	5
AP0154BH to AP0244BH		910	880	850	7	8

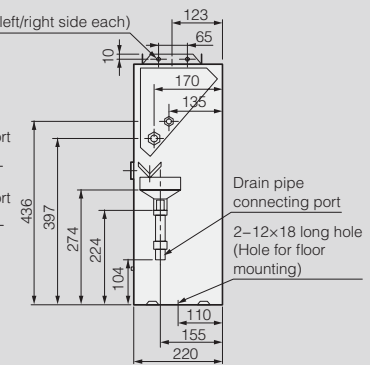
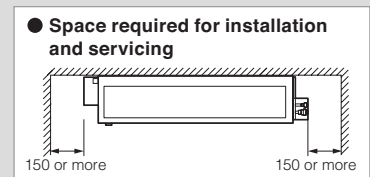

(Unit: mm)

Technical specifications

Model name	MML-	AP0074BH	AP0094BH	AP0124BH	AP0154BH	AP0184BH	AP0244BH	
Cooling/Heating capacity*1	(kW)	2.2/2.5	2.8/3.2	3.6/4.0	4.5/5.0	5.6/6.3	7.1/8.0	
Electrical characteristics	Power requirements	1-phase 50 Hz 230 V (220-240 V)/1-phase 60 Hz 220 V (Separate power supply for indoor units required.)						
	Power consumption 50 Hz/60 Hz	(kW)	0.056/0.058		0.090/0.096		0.095/0.110	
External dimensions	Height	(mm)	600				1045	
	Width	(mm)	745				1045	
	Depth	(mm)	220				220	
Total weight	(kg)	21				29		
Fan unit	Standard air flow (High/Mid/Low)	(m ³ /h)	460/400/300		740/600/490		950/790/640	
	Motor output	(W)	19		70			
Connecting pipe	Gas side	(mm)	φ9.5		φ12.7		φ15.9	
	Liquid side	(mm)	φ6.4				φ9.5	
	Drain port	(nominal dia.)	20 (Polyvinyl chloride tube)					
Sound pressure level*2 (High/Mid/Low)	(dB(A))	36/34/32				42/37/33		

*1 This reference piping consists of 5 m of main piping and 2.5 m of branch piping connected at the same height level.

*2 The actual values in an external operating environment are generally higher than the indicated values due to the contribution from ambient noise.



Floor Standing Cabinet Type

Slim & compact design

Under-window mounting does not block lighting.

Indoor unit size of 2.2 kW to 7.1 kW is the same.

Air exits from front or top

Distribution can be reversed to suit occupant preference.

Air blown from front panel (factory default)

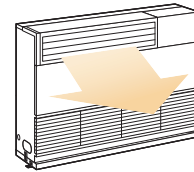

Air blown from top

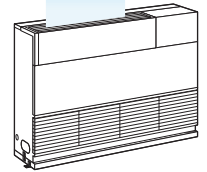

MML-AP***4H

MML-AP0074H to AP0244H

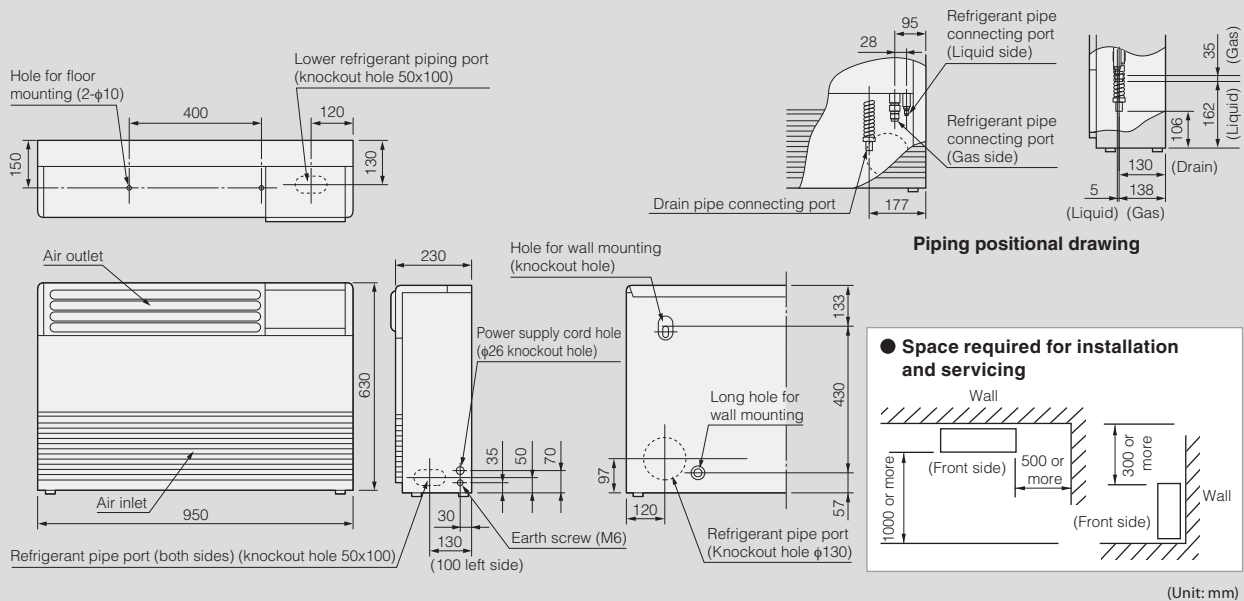

Technical specifications

Model name	MML-	AP0074H	AP0094H	AP0124H	AP0154H	AP0184H	AP0244H	
Cooling/Heating capacity*1	(kW)	2.2/2.5	2.8/3.2	3.6/4.0	4.5/5.0	5.6/6.3	7.1/8.0	
Electrical characteristics	Power requirements	1-phase 50 Hz 230 V (220-240 V) (Power exclusively for indoor is required.)/1-phase 60 Hz 220 V						
	Power consumption 50 Hz/60 Hz	(kW)	0.056/0.053		0.092/0.092		0.102/0.113	
External dimensions	Height	(mm)	630					
	Width	(mm)	950					
	Depth	(mm)	230					
Total weight	(kg)	37				40		
Fan unit	Standard air flow (High/Mid/Low)	(m ³ /h)	480/420/360		900/780/650		1080/930/780	
	Motor output	(W)	45				70	
Connecting pipe	Gas side	(mm)	ø9.5		ø12.7		ø15.9	
	Liquid side	(mm)	ø6.4					ø9.5
	Drain port	(nominal dia.)	20 (Polyvinyl chloride tube)					
Sound pressure level*2 (High/Mid/Low)	(dB(A))	39/37/35		45/41/38		49/44/39		

*1 This reference piping consists of 5 m of main piping and 2.5 m of branch piping connected at the same height level.

*2 The actual values in an external operating environment are generally higher than the indicated values due to the contribution from ambient noise.